

# Measure Straight Line

Follow **QUICK START** procedure to get Arrim ONE ready.

Tap **Function & Setting** and select **Line** function.

Function & Setting

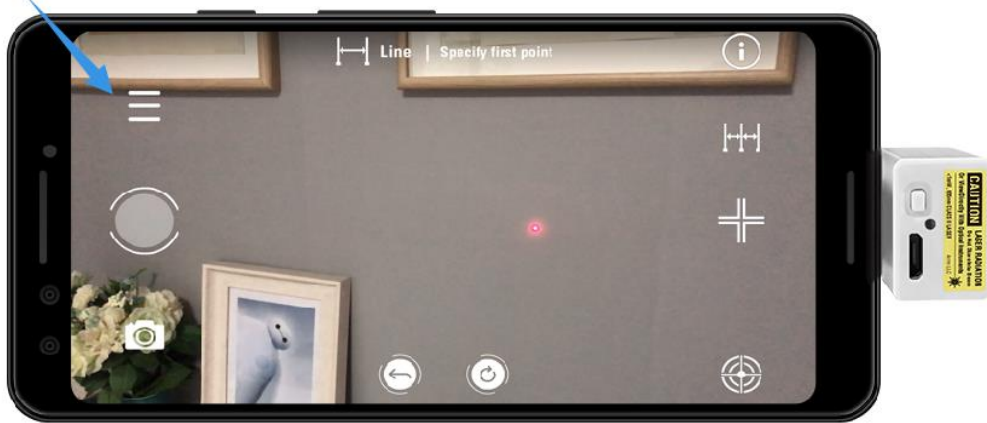

Aim the laser dot to the start of the line, and tap Measure button. A virtual dot will be placed there.

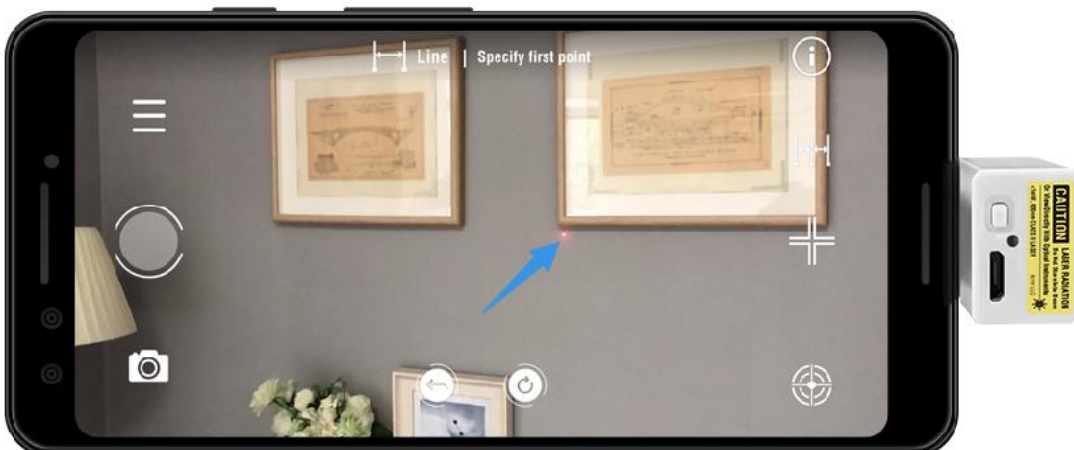

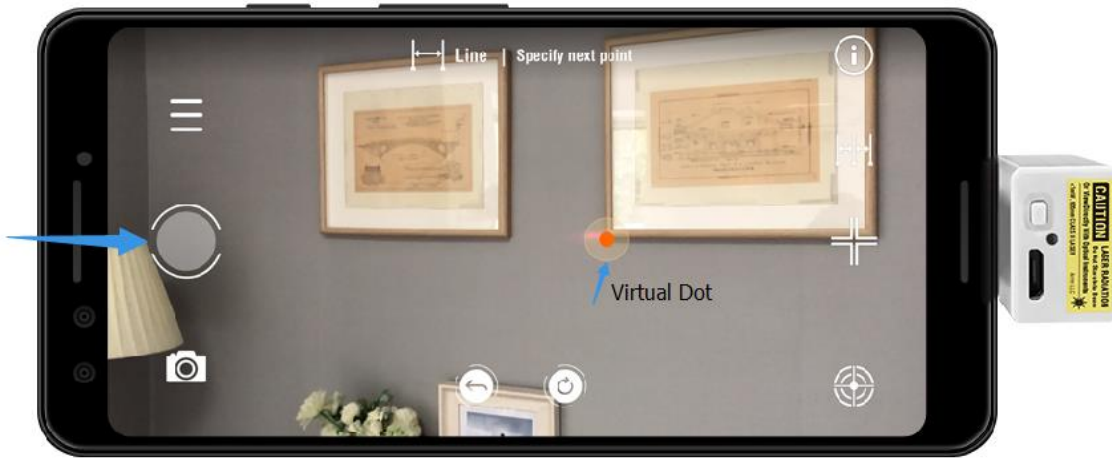

Aim the laser dot to the end of the line, and tap Measure button again, another virtual dot will be placed, and the measurement result will be shown.

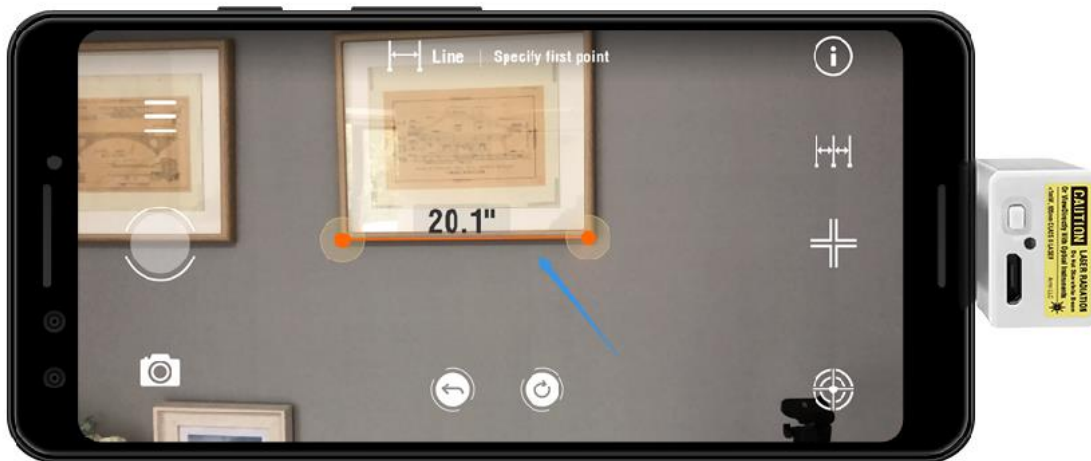

You can take a picture by tapping **Take Picture** button. When you first time use this function, it will ask permission to access the photos, media and files. Please click "Allow". The picture can be found in **Function & Setting > Folder**.



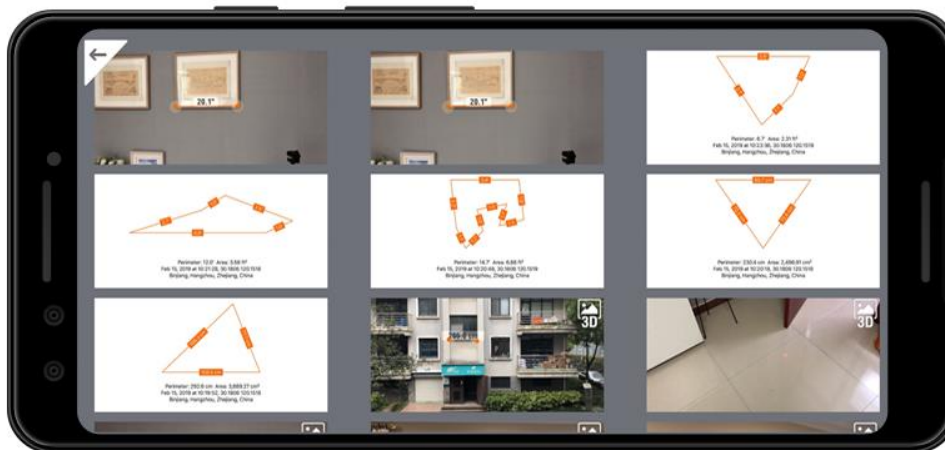
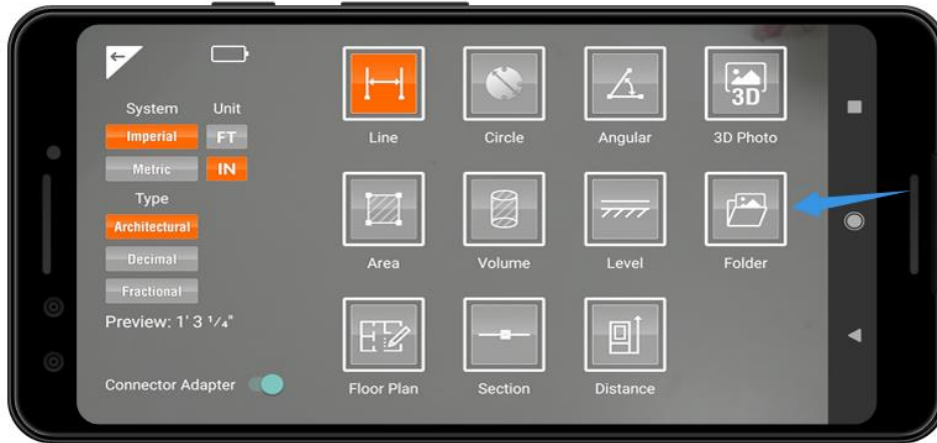
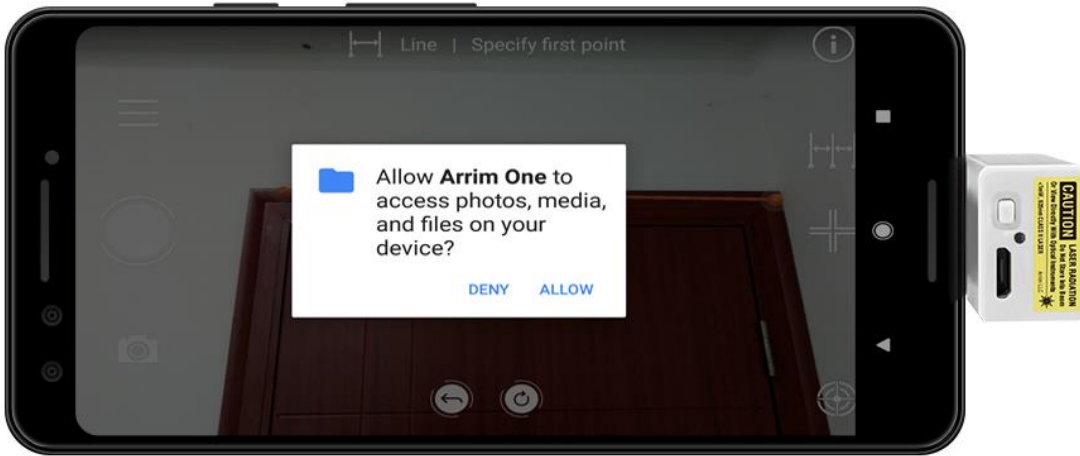

There are two support functions for Line measurement:

1. Continuous measurement

Tap the Continuous Button to activate it. You can do continuous measurement now.

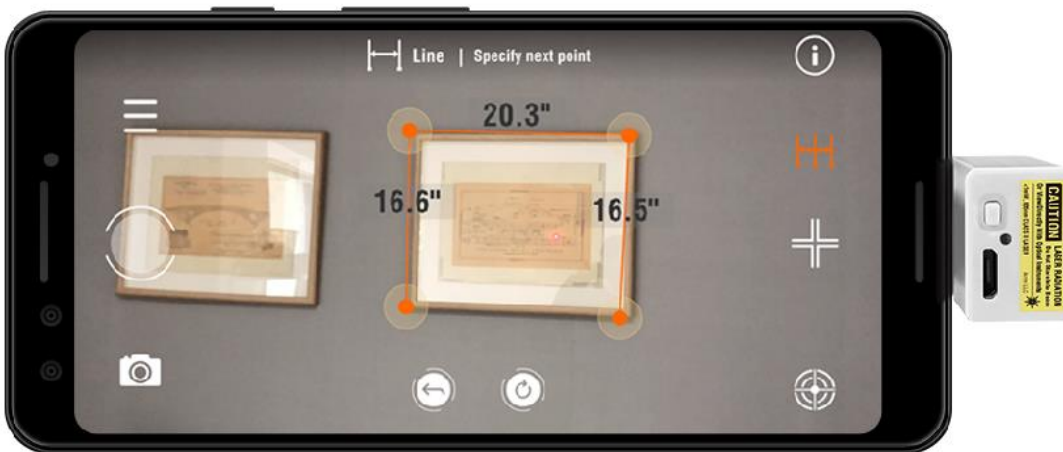

## 2. Horizontal / Vertical Measurement

To measure the distance **H** between a frame and floor as shown in the picture, aim the laser dot to the **Point 1**, and tap the **Measure** button, and then aim the laser dot to the **Point 2**. However, it is almost impossible to find the perfect vertical point by eyes, and you may end up with measuring the distance between **Point 1** and **Point 3** instead of **Point 1** and **Point 2**. The same situation if you want to know the distance **D** between Point 1 and the edge of the wall.

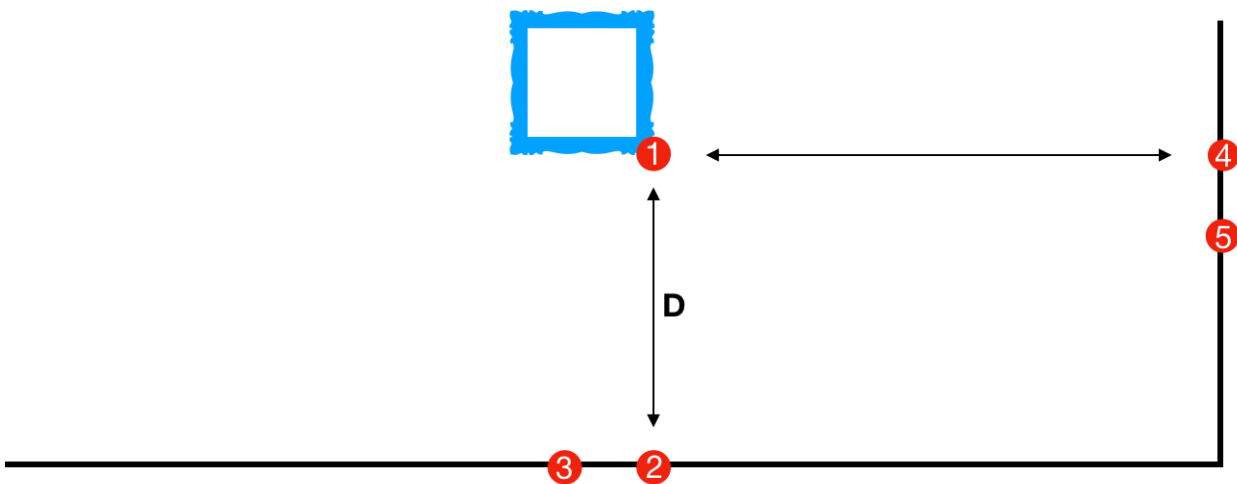

To solve this problem, you can tap the button to activate **Horizontal / Vertical Measurement** mode.

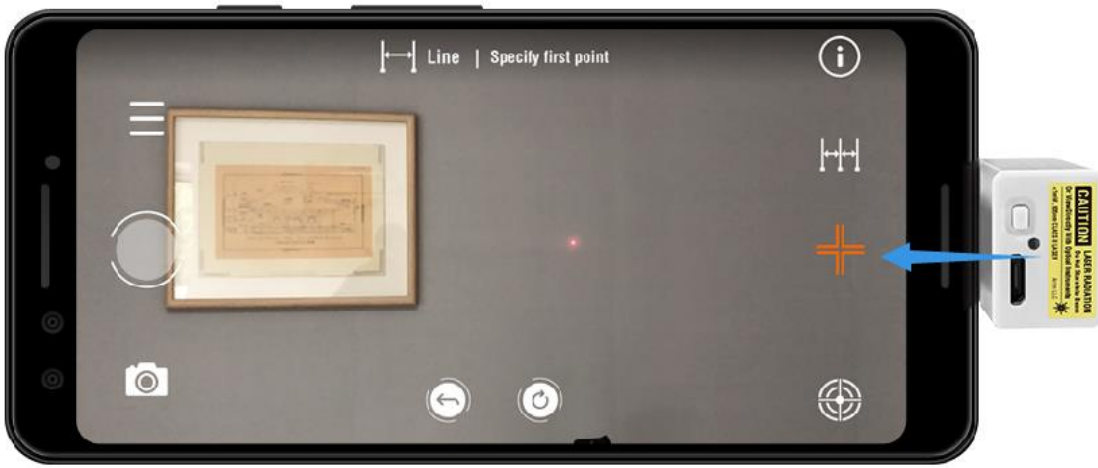

In this mode, you aim the laser dot to **Point A** and tap the **Measure** button. A plane and vertical line appears, and You aim the laser dot to edge of wall, and the software will automatically find the perfect horizontal **point B** on the edge and provide you the measurement of D. It works for vertical situation as well.

